

SUMMIT Kneeler



Comfor Tek Seating has designed a Kneeler to fit onto the SUMMIT 7700 Series Sanctuary Pew Chair. The design is well suited to accommodate the worship practices of an aging and growing (physical size) worship community. Shorter worshippers find it easy to engage, as they can do so without the need to reach forward (possibly losing their balance in the process).

Worshippers with large body profiles will find that by fully extending the kneeler (up to 13") they are able to position themselves so that their body weight is directly above their knees, providing unsurpassed comfort. The need to hold onto the chair to maintain one's balance is also eliminated.

Photo 1 and 2

The SUMMIT Kneeler is mounted to the chair frame by use of "c" channel which also acts as the rail for the roller bearing. A nylon cap, placed over the bearing ensures a smooth quiet operation. To engage the kneeler, the worshipper places his/her foot underneath the pad of the kneeler and pulls the unit outwards from the chair to which it is attached.

Photo 3

Fully extended the kneeler provides up to 13" of clearance.

Photo 4 and 5

After use, the worshiper again uses his/her foot to push the kneeler back into its stored position. In the stored position the kneeler is neatly tucked underneath. Exiting and cleaning functions are easily accommodated.



Removing the Kneelers / Stacking Chairs

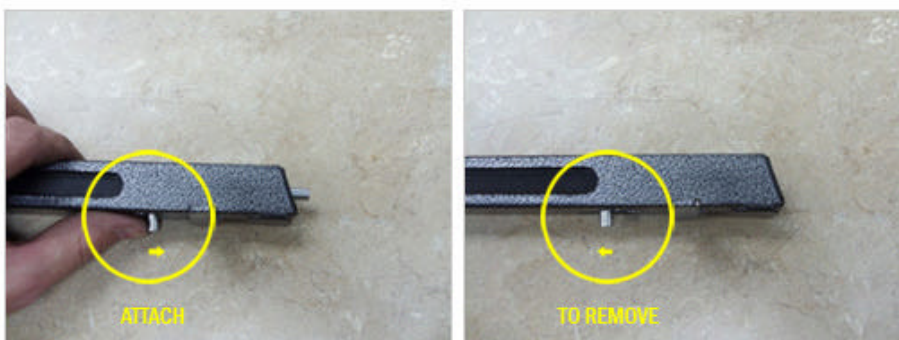

"Quick Attach" pins enable the kneeler to be removed for storage without the use for tools/hardware.

Other Kneeler Designs Available (1) LOOSE and (2) PIVOTING



1. LOOSE Foot Stool

Essentially, a free standing foot stool is placed underneath a chair, worshippers access the foot stool by pulling it out and positioning it between the rows when needed. The kneeler is then pushed forward and returned underneath the chair when not in use.

The awkwardness associated with the foot stool model relates more to cosmetics than to actual function. When stored, while some kneelers will be placed nicely underneath the chair, others will be randomly placed, some may even be positioned with legs that stick out past the rear legs of the chair. This increases efforts to clean/vacuum the sanctuary. Worshippers exiting the sanctuary may find themselves tripping over kneelers which were not carefully positioned underneath the chair.



2. PIVOTING Hinged Stool

This style, similar in design to the loose footstool, differs in that it is (pinned) to the rear leg of the chair. To activate, the worshiper leans forward, rotates/pivots the kneelers backwards down to the floor. After use, the kneeler is tipped/pivoted forward until it rests once again underneath the chair.

The process of pivoting the kneeler into place requires the worshipper to bend forward and pull the kneeler out with his/her hands. While taller worshippers may not experience any difficulty, those that are shorter will find it difficult to reach forward and support themselves while pivoting the kneeler into place and in some instances may have a tendency to fall out of their chair in the process.

Also, most pivoting styles of kneelers extend only 6-8 inches behind the chairs to which they are attached. This leaves worshippers in an awkward position as their legs are now in front of their upper body weight, leaving them off balance. This is particularly true if the worshipper is of a larger profile.

In more traditional settings, kneelers are attached to pews...maybe 6 to 12 feet in length. In those situations, one worshipper can reach down to pivot the kneeler into place for as many as four or six other worshippers. In pew chair seating, each worshipper is required to position their own kneeler, thus a person's physical size/height becomes an issue in the operation of the kneeler.